



FEATURES:

- Maintenance-free extruded aluminum
- Available in :
 - Mill Finish
 - White Finish
 - Bronze Finish
 - Beige Finish
- Triple track self-storing glass & screen inserts
- Drop-in vinyl glazing
- Wool pile weather-stripping
- High quality die-cast hardware
- Adjustable sill expander for perfect fit
- Removable inserts for ease of cleaning
- Wedge locks to minimize rattle
- Freedom from noise, drafts, insects
- Insulation for both heating and air conditioning
- Greatly reduced maintenance of prime windows
- Ease of changeover from insulation to ventilation
- Ease of installation; simple for "do-it-yourselfers"
- Increased protection

Door Tech aluminum storm windows are designed for beauty and engineered for service. Each unit is made from the finest materials and is carefully inspected to ensure perfection and customer satisfaction.

HOWtoMEASURE

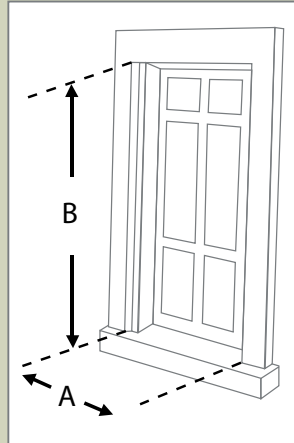

All measurements are taken from the outside and should be the door frame opening.

1. Take three measurements on width (A): top, center, and bottom. Use smallest figure.
2. Measure height (B) from top of opening to sill. Measure both sides and use smallest figure.

When ordering pre-hung doors, face the door from the outside and specify whether hinges are left-hand or right-hand.

Note: Windows should be ordered by frame opening size. Do not make allowances. We will make allowances.

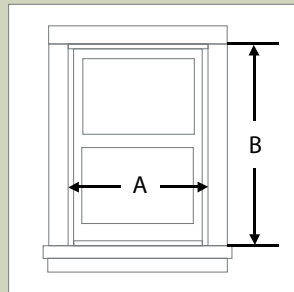

1. Measure opening width (A) at top, center, and bottom of window to be sure opening width is constant. If dimensions are not equal, select either the maximum or a compromise, as part of the storm window fin can be trimmed for a snug fit.

2. Measure opening height (B).

ACCESSDoor



The access door is manufactured with aluminum kick plate material and primarily used as a foundation crawl space door. This unique design may be adapted in a variety of situations and manufactured to most custom size requirements.



STORM Doors & Windows

Visit us at www.doortechllc.com

Proudly Manufactured in Lexington, NC - USA

SELFStoring SERIES STORM DOORS

FULLView DELUXE STORM DOOR



Starlite

Self Storing

- 1" Frame

Standard door sizes:

- 2' 8" x 6' 8"
- 2' 10" x 6' 10"
- 3' 0" X 6' 8"
- 3' 0" X 7' 0"

(limited custom sizes available)

Colors:

Mill - White - Bronze

Hardware Handle:

Black Exterior and Interior handle.



Deluxe

Full View

- 1 1/4" Frame

Standard door sizes:

- 2' 8" x 6' 8"
- 3' 0" X 6' 8"

(limited custom sizes available)

Colors:

White - Bronze - Beige

Hardware Handle:

Standard:

Lucite Tube

Accent Enhancement:

Polished Brass

Brushed Nickel

* screen optional on this model

Deluxe hardware options



Polished Brass Hardware:

- Contemporary, attractive handle design.
- Built-in latch lock.
- Optional Deadlock provided.
- Matching brass finish for interior handle.
- Brass tone expander adjusts for uneven sills.



Brushed Nickel Hardware:

- Contemporary, attractive handle design.
- Built-in latch lock.
- Optional Deadlock provided.
- Matching nickel finish for interior handle.
- Nickel tone expander adjusts for uneven sills.



Lucite Tube Handle: (Standard)

- Durable push-button handle.
- Exterior key-lock.
- Interior; security latch lock.

SELFStoring

ONELite DELUXE STORM DOOR

Deluxe

Self Storing

- 1 1/4" Frame

Standard door sizes:

- 2' 6" x 6' 8"
- 2' 8" x 6' 8"
- 3' 0" X 6' 8"
- 2' 10" x 6' 10"
- 3' 0" X 7' 0"

(limited custom sizes available)

Colors:

White - Bronze - Beige

Hardware Handle:

Standard:

Lucite Tube

Accent Enhancement:

Polished Brass

Brushed Nickel



Deluxe

One Lite

- 1 1/4" Frame

Standard door sizes:

- 2' 6" x 6' 8"
- 2' 8" x 6' 8"
- 3' 0" X 6' 8"
- 2' 10" x 6' 10"
- 3' 0" X 7' 0"

(limited custom sizes available)

Colors:

White - Bronze - Beige

Hardware Handle:

Standard:

Lucite Tube

Accent Enhancement:

Polished Brass

Brushed Nickel



* screen optional on this model

Starlite hardware handle



Black Finish Hardware:

- Contemporary, attractive handle design.
- Interior; security latch lock.

StormDoor features

Deluxe feature Starlite feature

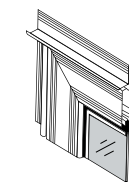

Drip Cap

At top of pre-hung Z bar. Door sheds water.

Deluxe feature Starlite feature

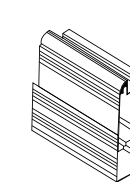

Built-In Expander

Located at the bottom of door. Can be adjusted up or down to fit uneven openings.

Deluxe feature

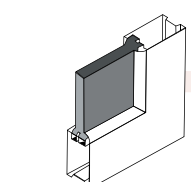

Insulated Kick Panel

Provides outstanding sound and weather insulation.

* French door kits available upon request for Deluxe doors only.